

UF/IFAS EXTENSION BAY COUNTY BUTTERFLY GARDEN

Created and Maintained by the Master Gardeners

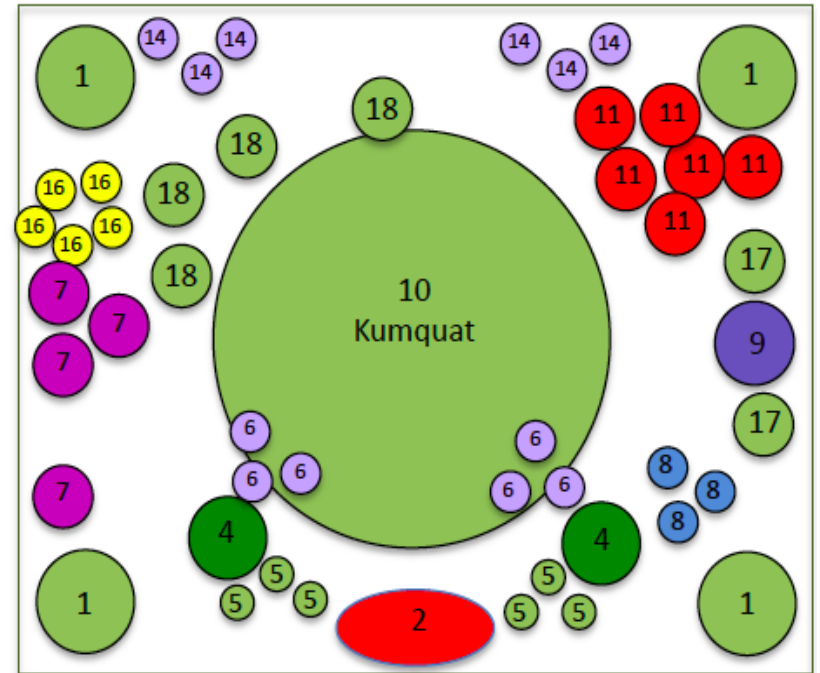
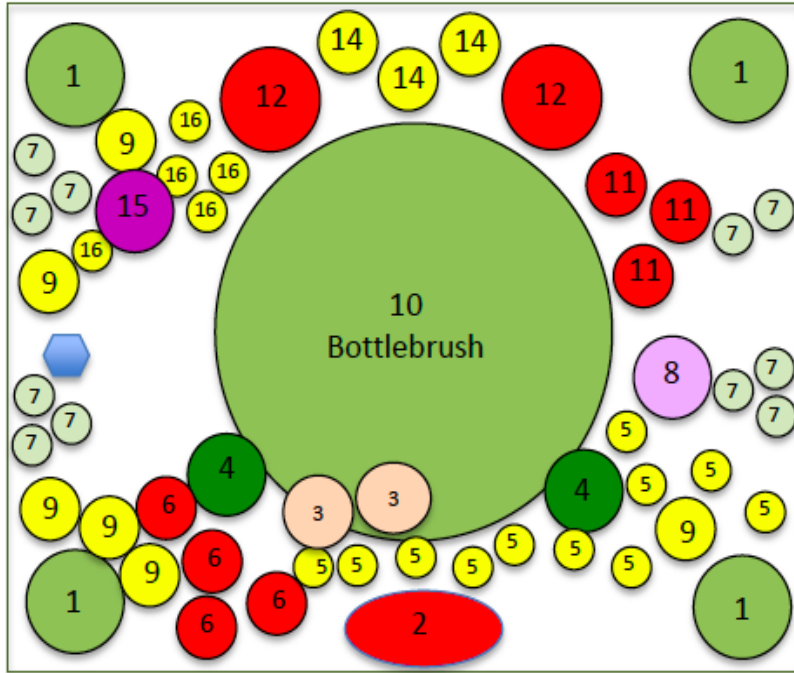

Bottlebrush Garden

- | | |
|-----------------------|--------------------------|
| 1. Coontie (L) | 12. Firespike |
| 2. Annuals | 13. Partridge Pea (L) |
| 3. Coral Nymph Salvia | 14. Rudbeckia lancialata |
| 4. African Iris | 15. Mexican Salvia |
| 5. Coreopsis | 16. Goldenrod |
| 6. Pentas | |
| 7. Garlic Chives | |
| 8. Dotted Horse Mint | |
| 9. Beach Sunflower | |
| 10. Bottlebrush | |
| 11. Salvia Coccinea | |

Cassia Garden

- | |
|-----------------------------|
| 1. Stokes Aster |
| 2. Mexican Heather |
| 3. Yellow Passionflower (L) |
| 4. Coreopsis |
| 5. Cassia (L) |
| 6. Maypop (L) |

Kumquat Garden

- | | |
|--------------------|----------------------------|
| 1. Coontie (L) | 12. Giant Ironweed (L) |
| 2. Annuals | 13. Yellow Thistle (L) |
| 3. Frogfruit (L) | 14. Society Garlic |
| 4. African Iris | 15. Milkweed (L) |
| 5. Parsley (L) | 16. Narrow Leaf Sunflowers |
| 6. Lyreleaf Sage | 17. Bronze Fennel (L) |
| 7. Echinaecea | 18. Fennel (L) |
| 8. Blue Eyed Grass | |
| 9. Porterweed | |
| 10. Kumquat (L) | |
| 11. Pentas | |